

HOW TO ACCESS YOUR EXAM

The online examinations use two separate platforms to administer the exam:

- 1) [eProctor Canada](#) – for virtual proctoring and live monitoring.
- 2) [AssessBank](#) – for viewing your exam.

You should sign into your exam **30 minutes** prior to your scheduled time to ensure you have the proper set up for the check-in process and eProctor can assist with any technical issues that may arise.

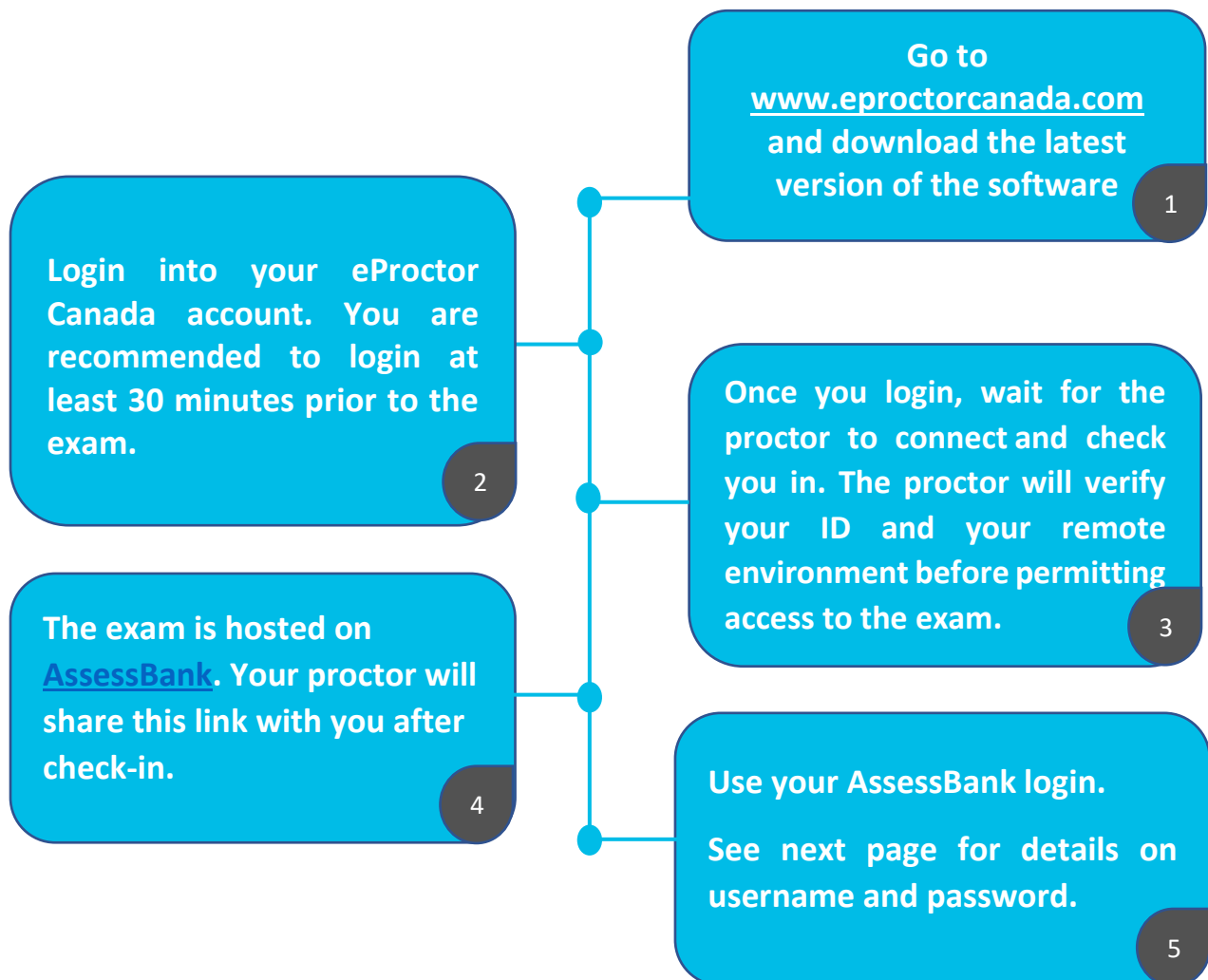



AssessBank Username & Password

Username/Login: your email Address (registered with your regulator)

**Note: this may be different from your eProctor Canada username.*

Password: your password is preset using your regulator's acronym (lowercase) and your Date of Birth (mmddyyyy)

<u>Regulator</u>	<u>Password Format:</u>
	Regulator acronym (lowercase) + underscore (“_”) + Your Date of Birth (mmddyyyy) <u>8 digits</u> Example: August 9, 1991 will be 08091991
Professional Engineers Ontario (PEO)	peo_date of birth Example: peo_08121991
Engineers and Geoscientists BC (EGBC)	egbc_date of birth Example: egbc_03091987
Association of Professional Engineers and Geoscientists Alberta (APEGA)	apega_date of birth Example: apega_02071980
Association of Professional Engineers and Geoscientists Saskatchewan (APEGS)	apegs_date of birth Example: apegs_08121983
Professional Geoscientists Ontario (PGO)	pgo_date of birth Example: pgo_07101990
Engineers Nova Scotia (APENS)	apens_date of birth Example: apens_04051970
Association of Professional Engineers and Geoscientists New Brunswick (APEGNB)	apegnb_date of birth Example: apegnb_08101995
Professional Engineers and Geoscientists Newfoundland and Labrador (PEGNL)	pegnl_date of birth Example: pegnl_01041981
Engineers PEI (EPEI)	epei_date of birth Example: epei_18121991